



## Quick Installation Guide

### Smart Meter

(CSI-GE01-1P-METER/CSI-GE01-3P-METER)

V1.0 -2022-07-15

## 01 Safety Precautions

### General Disclaimer

- The information in this quick installation guide is subject to change due to product updates or other reasons. All descriptions here are for guidance only.
- Before installations, read through the quick installation guide.
- All operations should be performed by trained and knowledgeable technicians who are familiar with local standards and safety regulations.
- Check the deliverables for correct model, complete contents, and intact appearance. Contact the manufacturer if any damage is found or any component is missing.
- Strictly follow the installation, operation, and configuration instructions in this guide and user manual. The manufacturer shall not be liable for equipment damage or personal injury if you do not follow the instructions.

### Safety Disclaimer



### WARNING

- Make sure that the device is powered off before any operations.
- Ensure the cables are connected tightly, securely, and correctly. Inappropriate wiring may cause poor contact or damage the device.
- Additional circuit breakers are recommended on the voltage input side to avoid personal injury or device damage.
- Specification of the protective fuse should be 0.5A.
- In areas at risk of lightning, if the device cable exceeds 10m and wired without grounded metal conduits, you are recommended to use an external lightning protection device.

### Check before Power-on

No.	Check Item
1	The product is firmly installed at a clean place that is well-ventilated and easy-to-operate.
2	The input power cables, CT Cables, and communication cables are connected correctly and securely.
3	Cable ties are intact, routed properly and evenly.

## Storage

If the equipment is not to be installed or used immediately, please ensure that the storage environment meets the following requirements:

- Do not unpack the outer package or throw the desiccant away.
- Store the equipment in a clean place. Make sure the temperature and humidity are appropriate and no condensation.
- If the smart meter has been long term stored, it should be checked by professionals before being put into use.

## 02 EU Declaration of Conformity

The module sold in the European market meets the following directives and requirements:

- Electromagnetic compatibility Directive 2014/30/EU (EMC)
- Electrical Apparatus Low Voltage Directive 2014/35/EU (LVD)
- Restrictions of Hazardous Substances Directive 2011/65/EU and (EU) 2015/863 (RoHS)
- Waste Electrical and Electronic Equipment 2012/19/EU
- Registration, Evaluation, Authorization and Restriction of Chemicals (EC) No 1907/2006 (REACH)

### 03 Technical Parameters

Model		CSI-GE01-1P-METER	CSI-GE01-3P-METER	
Input	Grid	Single phase	Three phase	
	Voltage	Nominal Voltage (Vac)	110/230	230/400
		Voltage Range (V)	100-240	100-240
		Nominal AC Grid Frequency (Hz)	50/60	50/60
	Current	CT In (A)	1CT: 120	3CTs: 120/200
Communication		RS485	RS485	
Communication Distance (m)		1000	1000	
User Interface		3 LEDs, Reset button	3 LEDs, Reset button	
Accuracy	Voltage/Current	Class 1	Class 1	
	Active Energy	Class 1	Class 1	
	Reactive Energy	Class 2	Class 2	
Power Consumption (W)		< 3	< 3	
Structural Parameters	Dimensions (W×H×D, mm)	36 × 85 × 66.5	36 × 85 × 66.5	
	Housing	2 modules	2 modules	
	Weight (g)	270	450	
	Mounting	DIN rail	DIN rail	
Environmental Parameters	Protection Degree	IP20	IP20	
	Operating Temperature Range (°C)	-25 ~ +60	-25 ~ +60	
	Storage Temperature Range (°C)	-25 ~ +60	-25 ~ +60	
	Operating Humidity (%)	< 95	< 95	
	Max. Operating Altitude (m)	2000	2000	

## 04 Product Introduction

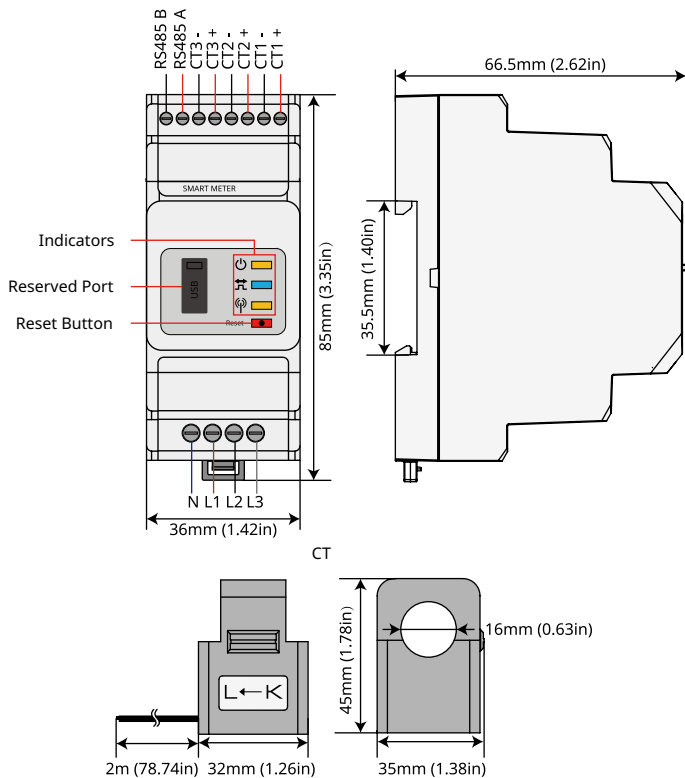

## 05 Installation

### Packing List

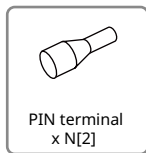
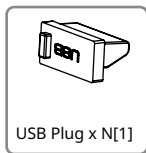
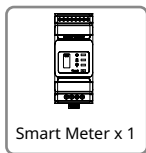

[1]: For CSI-GE01-1P-METER and CSI-GE01-3P-METER.

[2]: CSI-GE01-1P-METER x 4; CSI-GE01-3P-METER x 6.

### Installation and Cable Connection

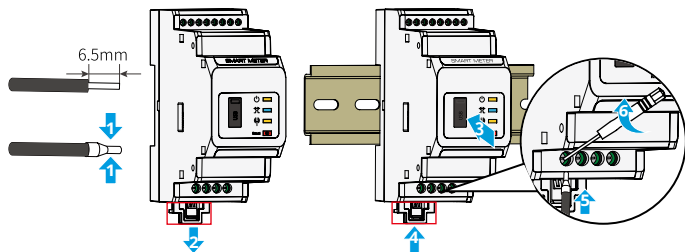

## 06 Wiring System

### CSI-GE01-1P-METER

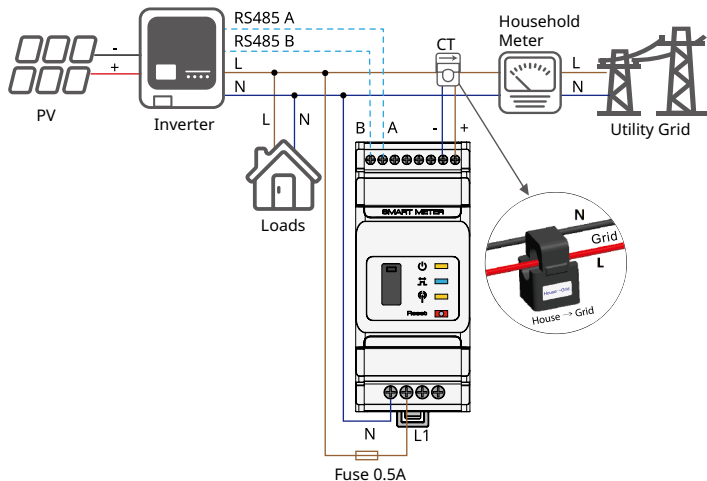

- Recommended cable connected to the voltage input terminal: 1mm<sup>2</sup> (17AWG).
- CT direction: House (K)-->Grid (L).

## CSI-GE01-3P-METER

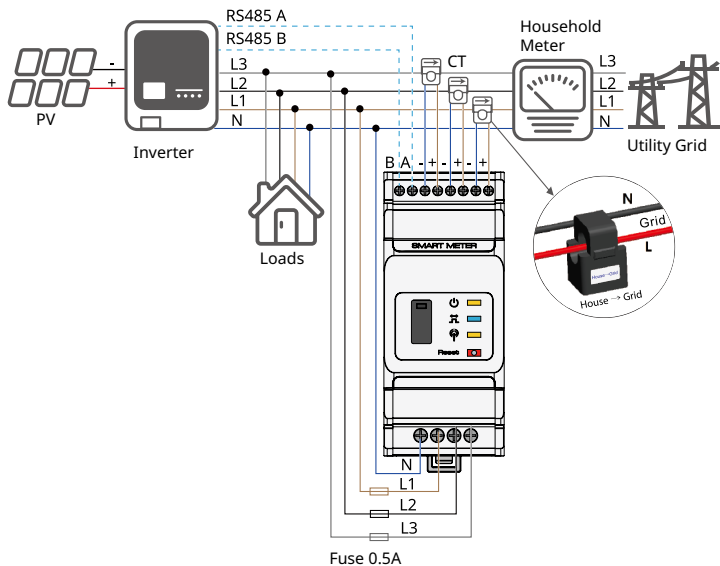

- Recommended cable connected to the voltage input terminal: 1mm<sup>2</sup> (17AWG).
- CT direction: House (K)-->Grid (L).





## 07 Commissioning

### Power ON

**Step 1** Connect the smart meter cables.

**Step 2** Power on the inverter and make sure that the inverter is working normally. Then the smart meter is powered on.

### Indicator

Type	Status	Description
	Steady on	Power on
	Off	Power off
	Steady on	Importing from the grid.
	Blinking	Exporting to the grid.
	Blinking	Communication is OK.
	Blink 5	The meter is resetting

### Reset Button

Press Time	Description
< 3s	Reset the smart meter.
5s	Restory factory settings.
>10s	Restory factory settings and clear the historical energy data.

# Contact Information

## EMEA MSS HQ

Canadian Solar EMEA GmbH  
Radlkofenstrasse 2, 81373 Munich, Germany  
[Sales.emea@csisolar.com](mailto:Sales.emea@csisolar.com) (Sales Inquiries)

## Germany

Canadian Solar EMEA GmbH  
Radlkofenstrasse 2, 81373 Munich, Germany  
[Sales.emea@csisolar.com](mailto:Sales.emea@csisolar.com) (Sales Inquiries)  
[Inverter.support-de@csisolar.com](mailto:Inverter.support-de@csisolar.com) (Service)

## Spain

[Sales.emea@csisolar.com](mailto:Sales.emea@csisolar.com) (Sales Inquiries)  
[Inverter.support-es@csisolar.com](mailto:Inverter.support-es@csisolar.com) (Service)

## France

[Sales.emea@csisolar.com](mailto:Sales.emea@csisolar.com) (Sales Inquiries)  
[Inverter.support-fr@csisolar.com](mailto:Inverter.support-fr@csisolar.com) (Service)

## Italy

[Sales.emea@csisolar.com](mailto:Sales.emea@csisolar.com) (Sales Inquiries)  
[Inverter.support-it@csisolar.com](mailto:Inverter.support-it@csisolar.com) (Service)

## Poland

[Sales.emea@csisolar.com](mailto:Sales.emea@csisolar.com) (Sales Inquiries)  
[Inverter.support-pl@csisolar.com](mailto:Inverter.support-pl@csisolar.com) (Service)

## South Africa

[Sales.emea@csisolar.com](mailto:Sales.emea@csisolar.com) (Sales Inquiries)  
[Inverter.support-sa@csisolar.com](mailto:Inverter.support-sa@csisolar.com) (Service)



Scan for more details



340-00837-00